

CSW ST2

ENGINEERING
LANDSCAPE ARCHITECTURE
SURVEYING
URBAN PLANNING
504 REDWOOD BLVD #310
NOVATO, CA 94947
415.883.9850
WWW.CSWST2.COM ©2025

Rev	Date	Description	Designed	Drawn	Checked

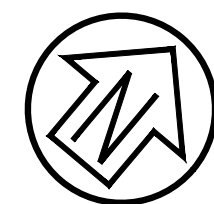
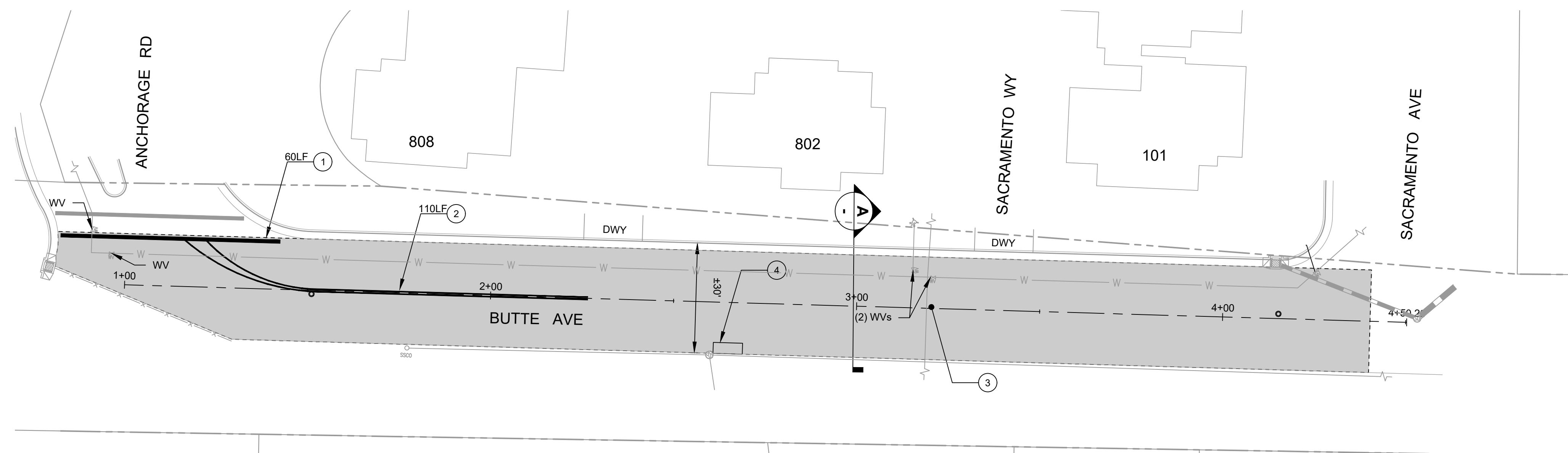

Graphic Scale (in feet)

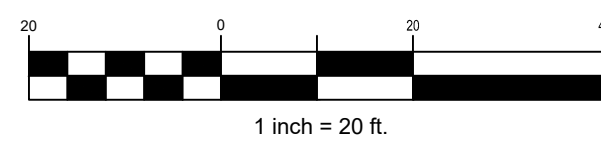

NOTES

1. PAVEMENT STRIPING AND MARKINGS PER CALTRANS STANDARD PLANS.
2. ADJUST ALL UTILITY FRAMES AND COVERS TO GRADE.
3. ADJUST ALL SURVEY MONUMENT COVERS TO GRADE PER UCS DWG 300.
4. APPLY TACK COAT BETWEEN NEW & EX. PAVEMENT.
5. DIGOUT LOCATIONS TO BE MARKED BY ENGINEER.

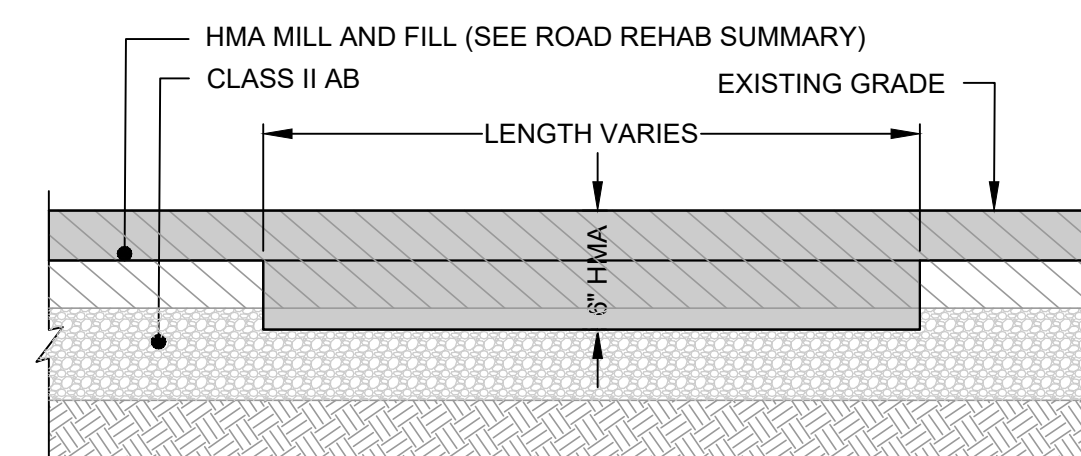

NOTE:
PROVIDE TACK COAT ON EX. PAVEMENT SURFACES

DIGOUT DETAIL
N.T.S.

LEGEND

- ROADWAY REHABILITATION, SEE SECTION DETAIL, THIS SHEET
- PAVEMENT MARKINGS WORDS (CALTRANS STD. PLAN A24D)
- SURVEY MONUMENT

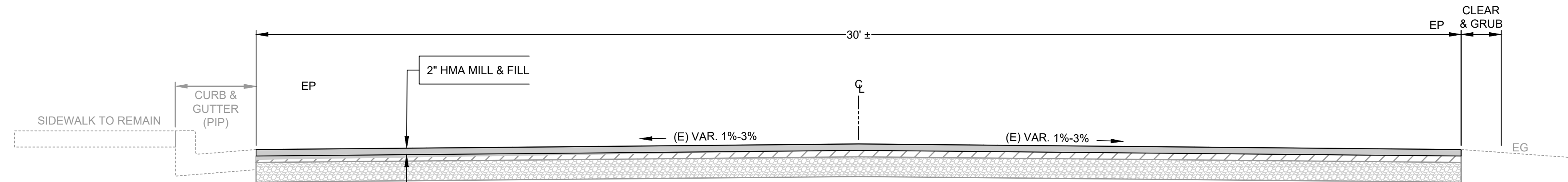

SECTION A
SCALE: 1" = 2'

KEYNOTES

1. STANDARD CROSSWALK (12-INCH - WHITE) PER CALTRANS STD DETAIL A24E
2. CALTRANS STD DETAIL 21
3. BLUE REFLECTIVE PAVEMENT MARKER
4. HMA FILL ±3" FOR DEPRESS AT SSMH

ROAD REHABILITATION SUMMARY

ROAD NAME	BEGIN	END	DIGOUTS DEPTHS	REHABILITATION
BUTTE ST	ANCHORAGE	SACRAMENTO	6"	2" HMA MILL & FILL

SAUSALITO 2024 PAVING
PAVEMENT REHABILITATION
BUTTE ST
(ANCHORAGE RD TO SACRAMENTO AVE)
SAUSALITO, CALIFORNIA

City Of
Sausalito
County Of
Marin
State Of
California

Prepared Under the Direction of:



Sheet
4
Scale: 1 inch = 20 ft.
Date: JULY 30, 2025
Sheet Number: 4 OF 25

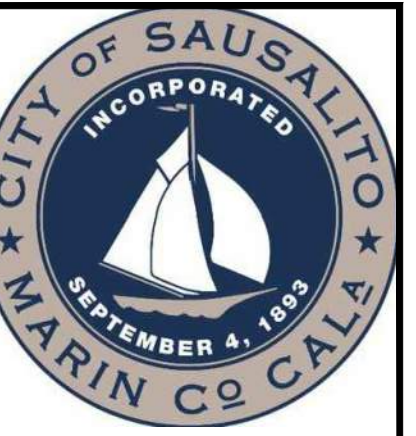

CSW ST2

ENGINEERING
LANDSCAPE ARCHITECTURE
SURVEYING
URBAN PLANNING
504 REDWOOD BLVD #310
NOVATO, CA 94947
+1.863.9850
WWW.CSWST2.COM ©2025

Rev	Date	Description	Designed	Checked

SAUSALITO 2024 PAVING
PAVEMENT REHABILITATION
ARANA CIR
(END TO END)
SAUSALITO, CALIFORNIA

City Of
Sausalito
County Of
Marin
State Of
California

Prepared Under the Direction of:



Sheet
5
Scale: 1 inch = 20 ft.
Date: JULY 30, 2025
Sheet Number: 5 OF 25

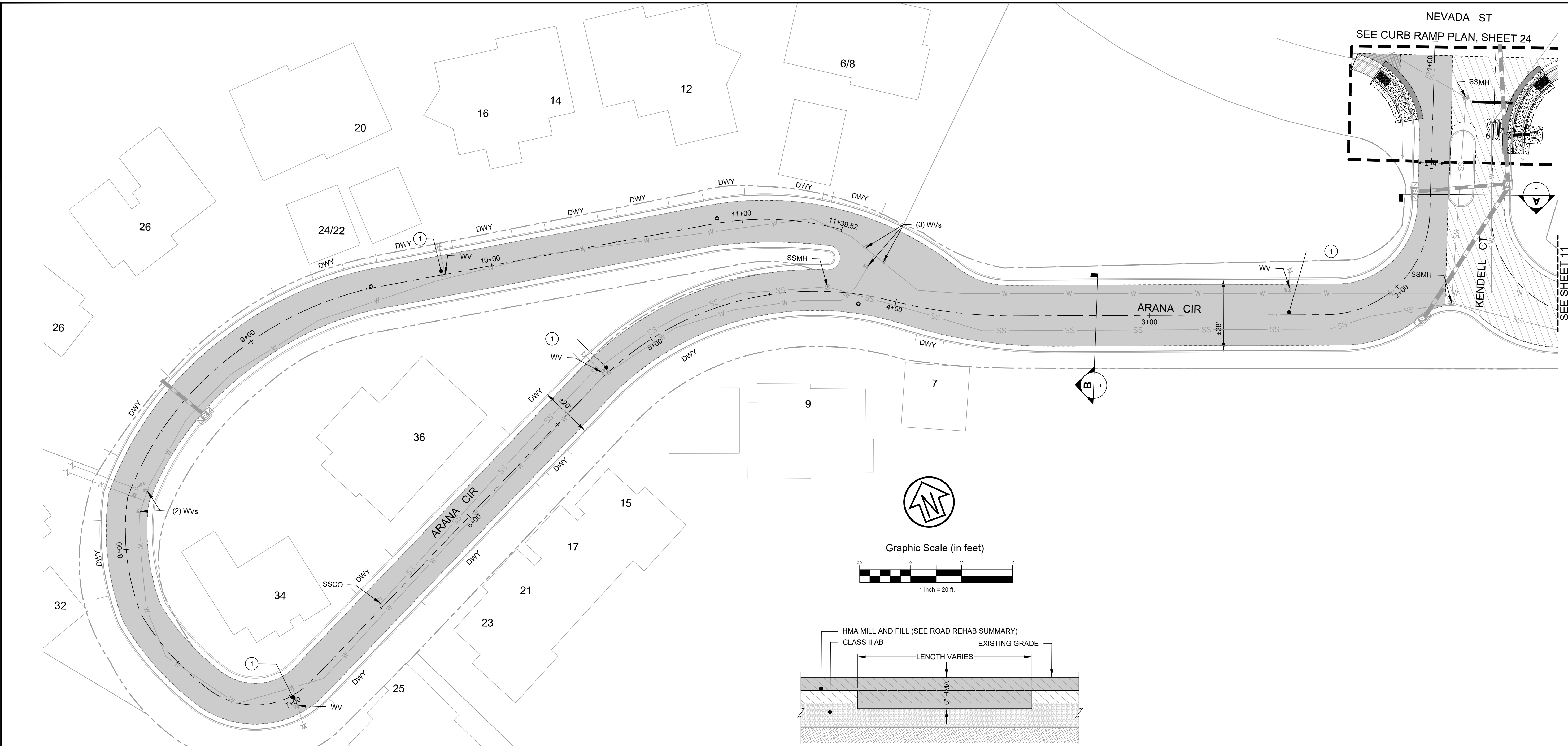

- NOTES**
1. PAVEMENT STRIPING AND MARKINGS PER CALTRANS STANDARD PLANS.
 2. ADJUST ALL UTILITY FRAMES AND COVERS TO GRADE.
 3. ADJUST ALL SURVEY MONUMENT COVERS TO GRADE PER UCS DWG 300.
 4. APPLY TACK COAT BETWEEN NEW & EX. PAVEMENT.
 5. DIGOUT LOCATIONS TO BE MARKED BY ENGINEER.

- LEGEND**
- ROADWAY REHABILITATION. SEE SECTION DETAIL, THIS SHEET
 - UCS #105 TYPE "A" SIDEWALK
 - MINOR EARTHWORK - INSTALL 4" MULCH OVER DISTURBED AREAS
 - PAVEMENT MARKINGS WORDS (CALTRANS STD. PLAN A24D)
 - SURVEY MONUMENT

- KEYNOTES**
- ① BLUE REFLECTIVE PAVEMENT MARKER

ROAD REHABILITATION SUMMARY

ROAD NAME	BEGIN	END	DIGOUTS DEPTHS	REHABILITATION
ARANA CIR	-	-	6"	2" HMA MILL & FILL

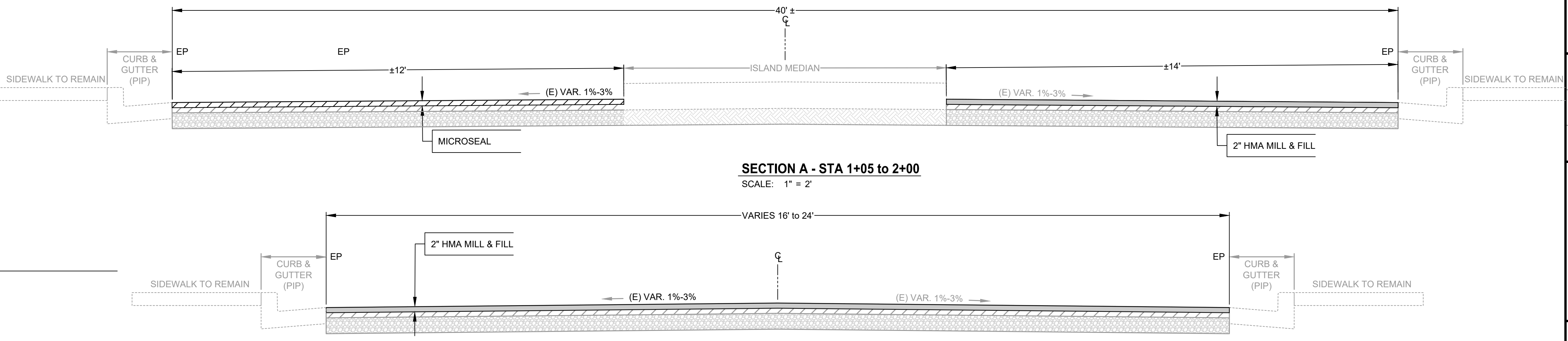
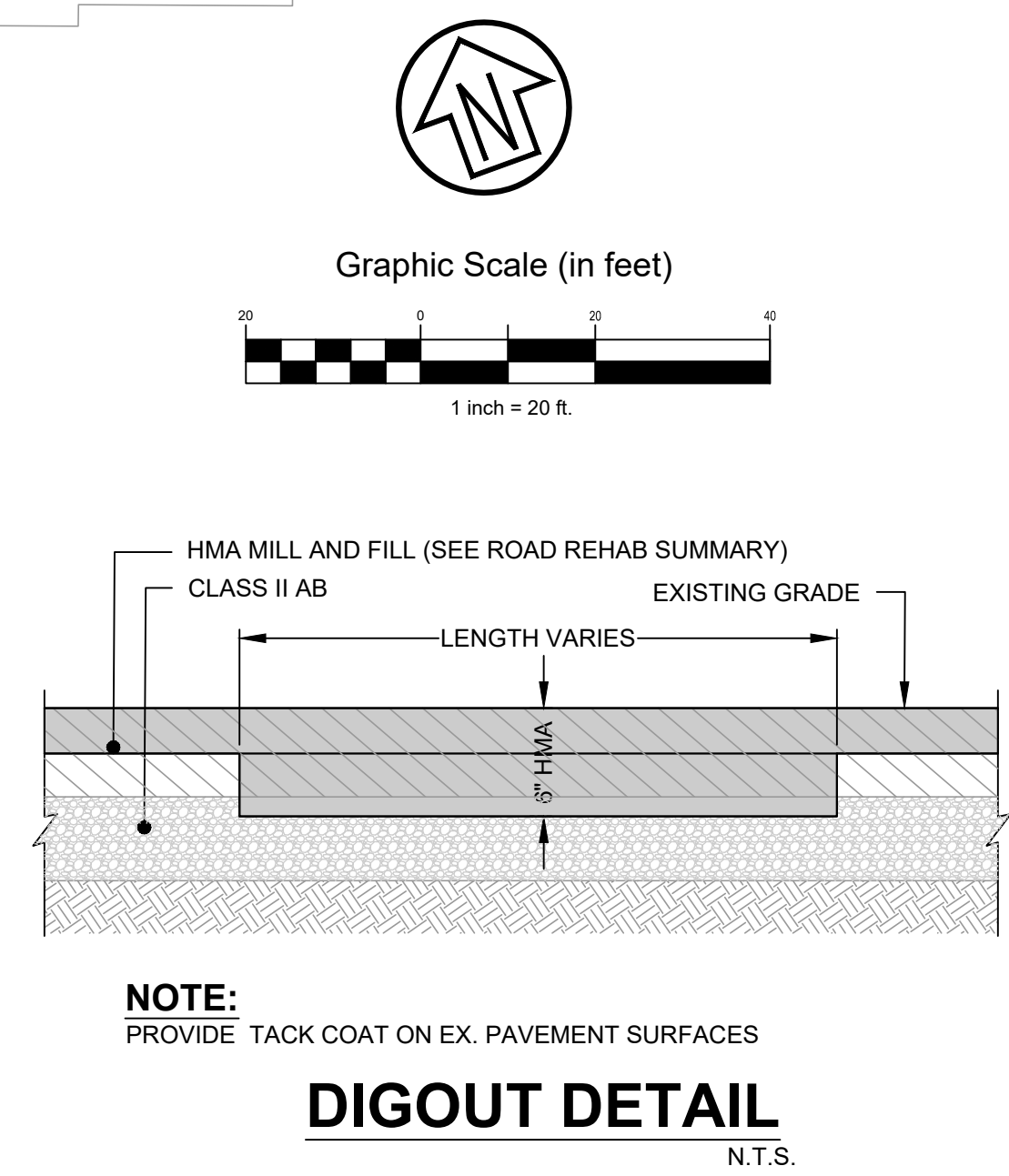



CSW ST2

ENGINEERING
LANDSCAPE ARCHITECTURE
SURVEYING
URBAN PLANNING
504 REDWOOD BLVD #310
NOVATO, CA 94947
+1.563.9850
WWW.CSWST2.COM ©2025

Checked	Drawn	Designed	Description	Date	Rev

SAUSALITO 2024 PAVING
PAVEMENT REHABILITATION
LOCUST ST
(BRIDGEWAY to END)
SAUSALITO, CALIFORNIA

City Of
Sausalito
County Of
Marin
State Of
California

Prepared Under the Direction of:



Sheet

7

Scale: 1 inch = 10 ft.

Date: JULY 30, 2025

Sheet Number: 7 OF 25

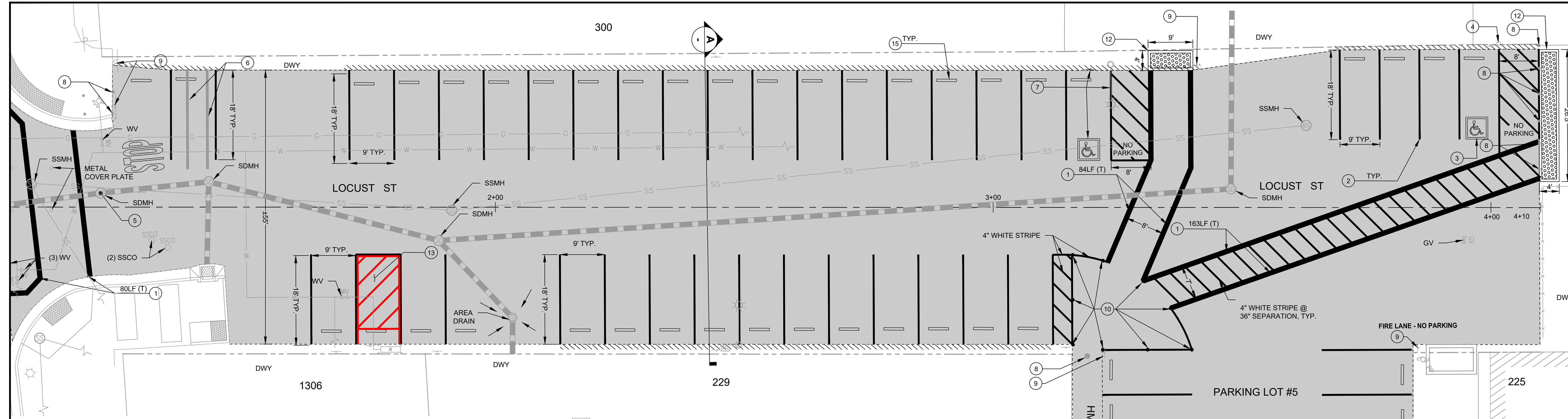

LEGEND

- ROADWAY REHABILITATION. SEE SECTION DETAIL, THIS SHEET
- PAVEMENT MARKINGS WORDS (CALTRANS STD. PLAN A24D)
- SURVEY MONUMENT

KEYNOTES

- STOP BAR/LIMIT LINE STRIPE (12-INCH - WHITE) PER CALTRANS STD DETAIL A24E
- 4" THERMOPLASTIC ANGLE PARKING STRIPE. MATCH EX LOCATIONS
- INTERNATION SYMBOL OF ACCESSIBILITY TO BE 36"x36" ON A BLUE BACKGROUND PER CURRENT ADA GUIDELINES
- ACCESS AISLE BORDER TO BE BLUE WITH WHITE OR BLUE DIAGONAL HATCH LINES 36" ON-CENTER WITH 12" MIN WHITE "NO PARKING" LETTERING
- BLUE REFLECTIVE PAVEMENT MARKER
- REMOVE & DISPOSE UP TO 40LF OF RAILROAD RAILS AND TIES BELOW AC PAVEMENT AS NECESSARY FOR PAVEMENT IMPROVEMENTS
- THERMOPLASTIC STRIPING AND SIGNAGE FOR ADA PARKING STALL PER CALTRANS STD PLAN A90A.
- PROTECT IN PLACE EX BOLLARDS
- PROTECT IN PLACE EX SIGN
- INSTALL K-71 PLASTIC BOLLARD
- REMOVE AND RESET EXISTING SIGN & POST PER UCS #310
- INSTALL CONCRETE PAD WITH TRUNCATED DOMES (SEE DETAIL, THIS SHEET)
- 4" RED PAINT STRIPPING TO MATCH EXISTING
- REMOVE & DISPOSE 3 EA PARKING LOG TIMBER LOGS (±10" DIAMETER x ±12' LOGS) AND REBAR ANCHORS
- WHEEL STOP. SALVAGE & RESET INTACT (20 TOTAL) WHEEL STOPS & REPLACE BROKEN WHEEL STOPS AT LOCATIONS AS INDICATED.

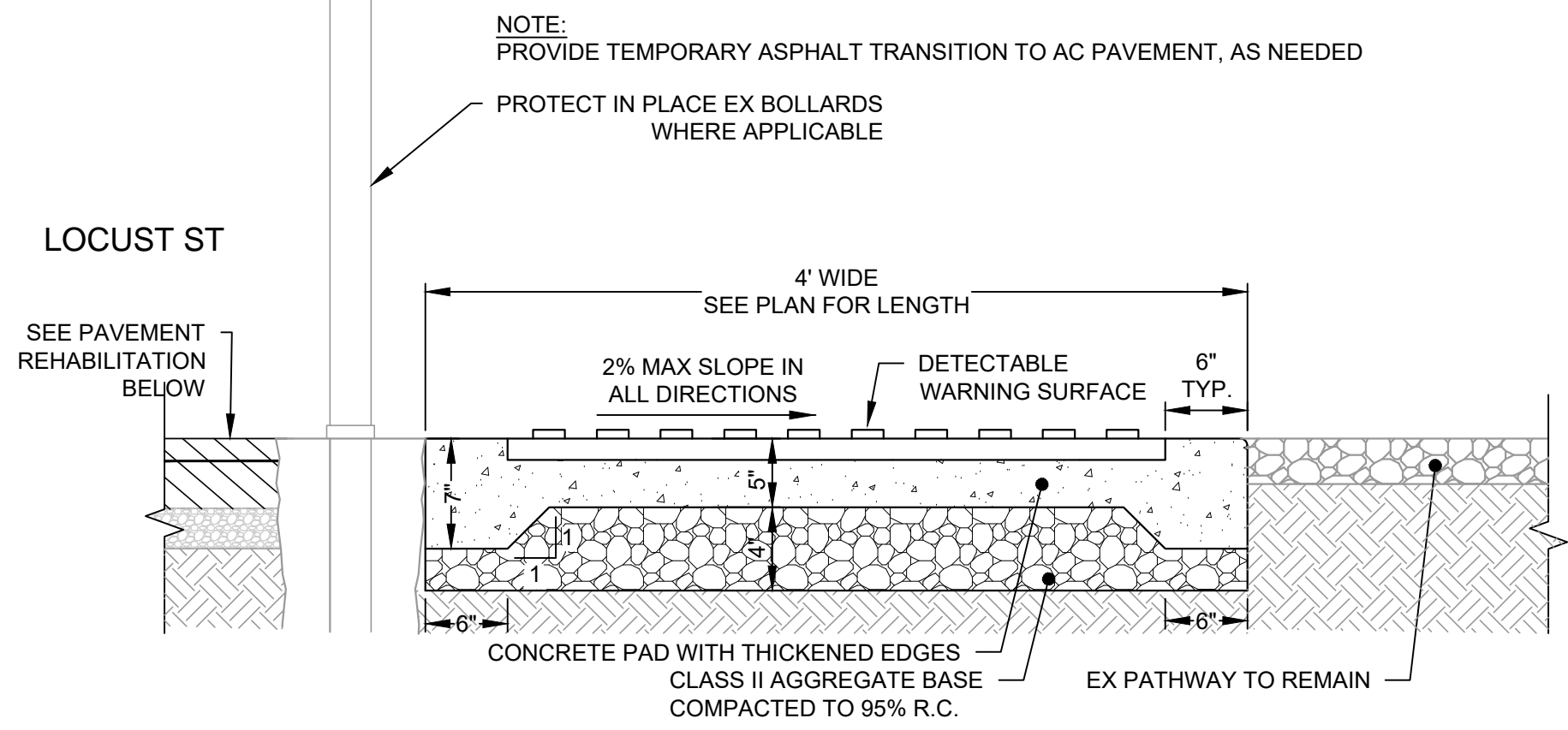

CONCRETE PAD FOR DETECTABLE WARNING SURFACE

SCALE: NTS

NOTES

- PAVEMENT STRIPING AND MARKINGS PER CALTRANS STANDARD PLANS.
- ADJUST ALL SURVEY MONUMENT COVERS TO GRADE.
- ADJUST ALL SURVEY MONUMENT COVERS TO GRADE PER UCS DWG 300.
- APPLY TACK COAT BETWEEN NEW & EX. PAVEMENT.
- DIGOUT LOCATIONS TO BE MARKED BY ENGINEER.
- PROTECT IN PLACE EXISTING SIGNAGE & BOLLARDS.
- MAINTAIN 2% MAXIMUM SLOPE WITHIN CROSSWALK.

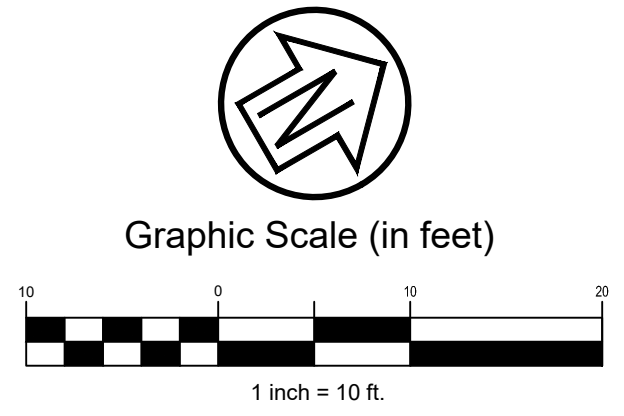

ROAD REHABILITATION SUMMARY

ROAD NAME	BEGIN	END	DIGOUTS DEPTHS	REHABILITATION
LOCUST ST	BRIDGEWAY	END	N/A	6" MILL / 2" HMA OVER FABRIC OVER 4"HMA

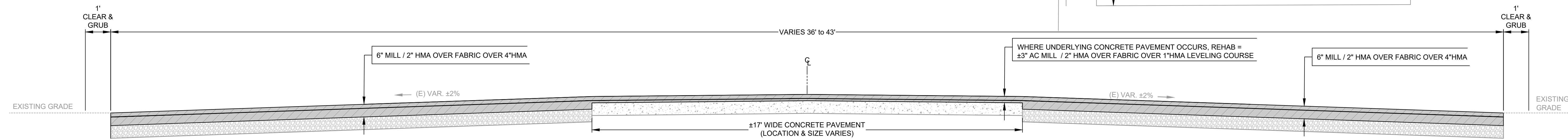

SECTION A

SCALE: 1" = 2'

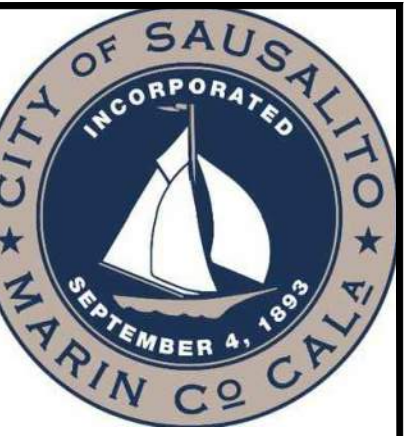

CSW ST2

ENGINEERING
LANDSCAPE ARCHITECTURE
SURVEYING
URBAN PLANNING
504 REDWOOD BLVD #310
NOVATO, CA 94947
415.883.9850
WWW.CSWST2.COM ©2025

Rev	Date	Description	Designed	Drawn	Checked

SAUSALITO 2024 PAVING
PAVEMENT REHABILITATION
NAPA ST, ANCHOR ST,
KENDELL CT, & EL PORTAL
SAUSALITO, CALIFORNIA

City Of
Sausalito
County Of
Marin
State Of
California

Prepared Under the Direction of:



Sheet
11
Scale: 1 inch = 20 ft.
Date: JULY 30, 2025
Sheet Number: 11 OF 25

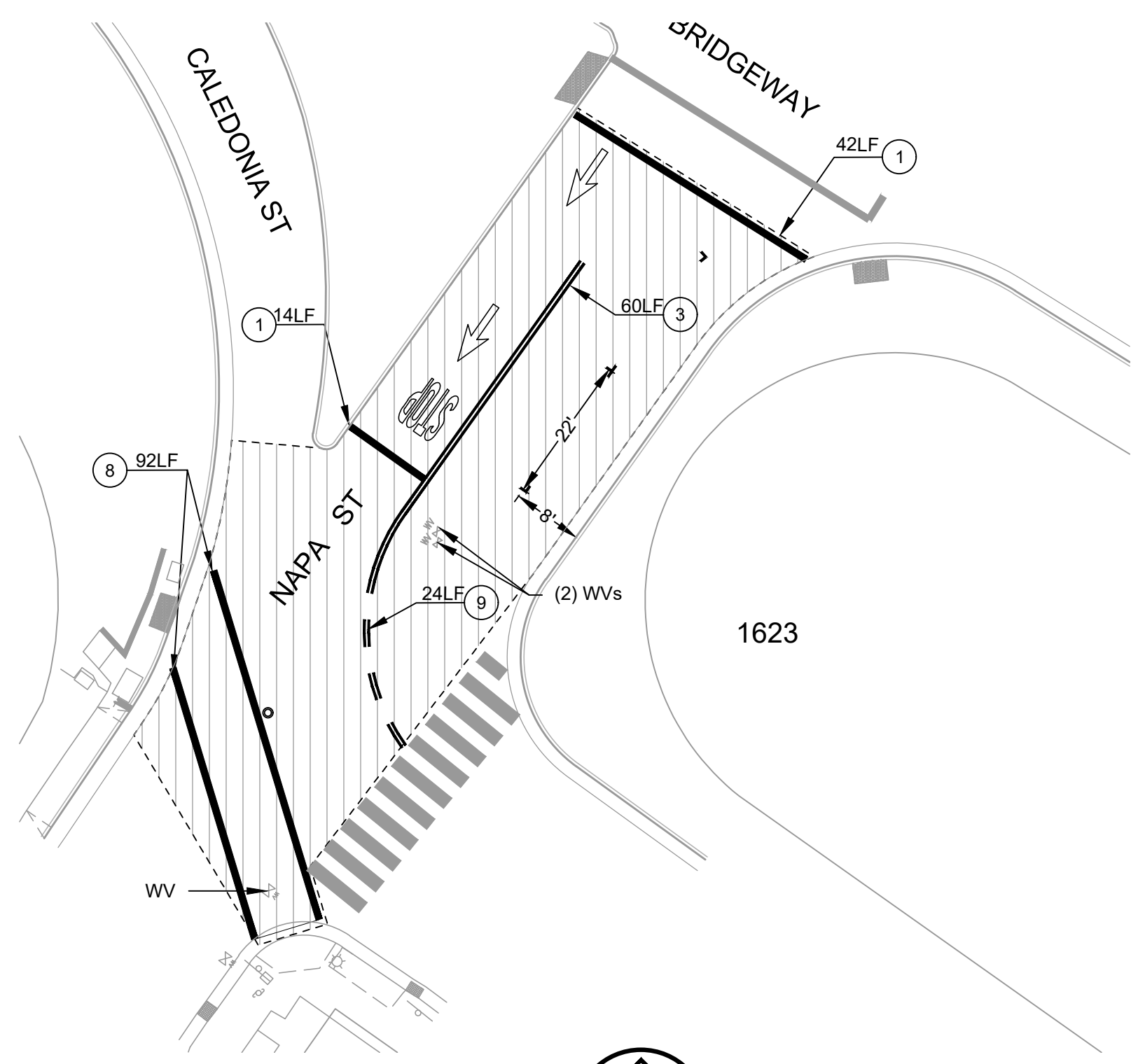

NAPA ST
SCALE: 1 inch = 20 ft

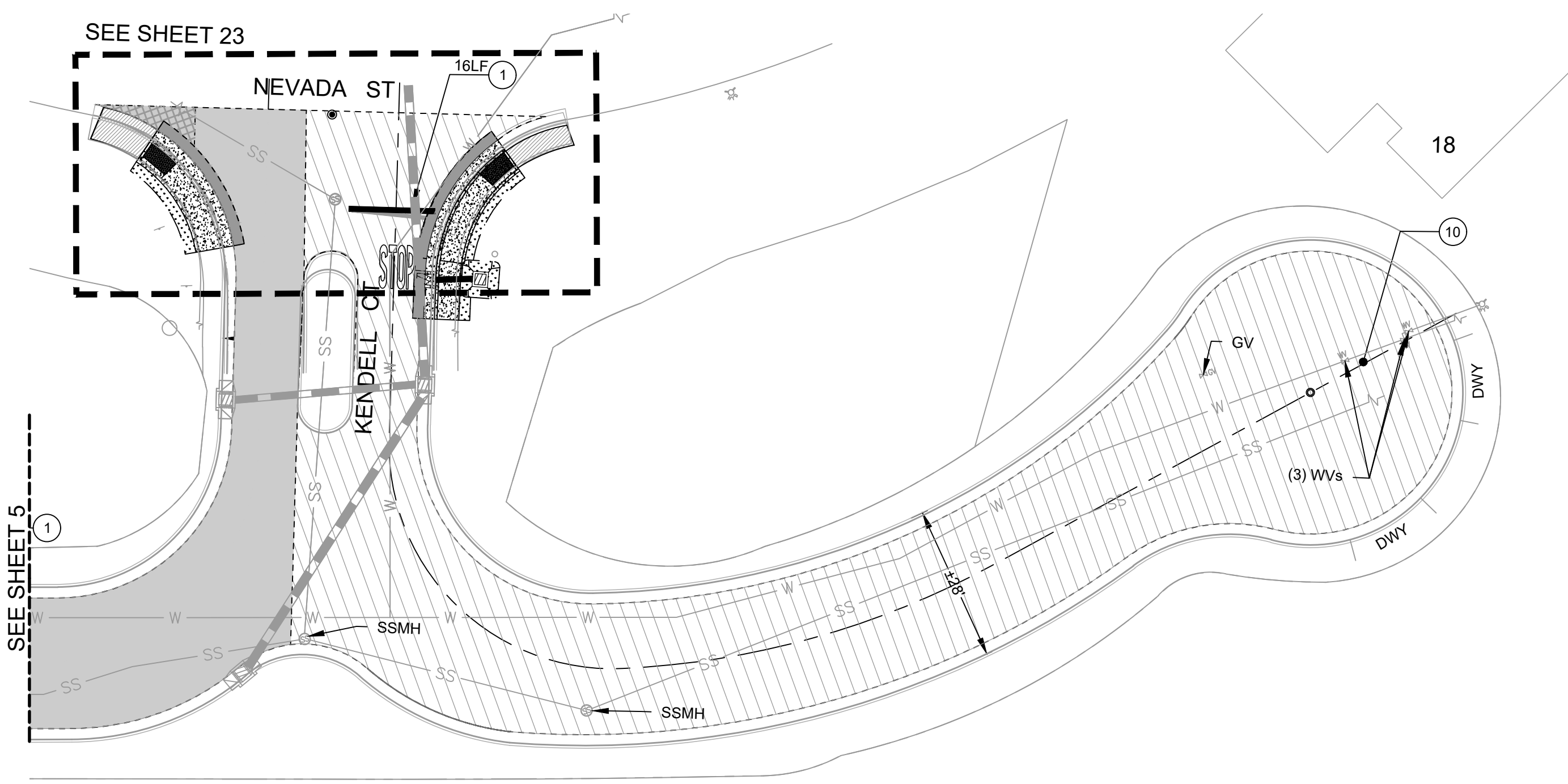

KENDELL CT
SCALE: 1 inch = 20 ft

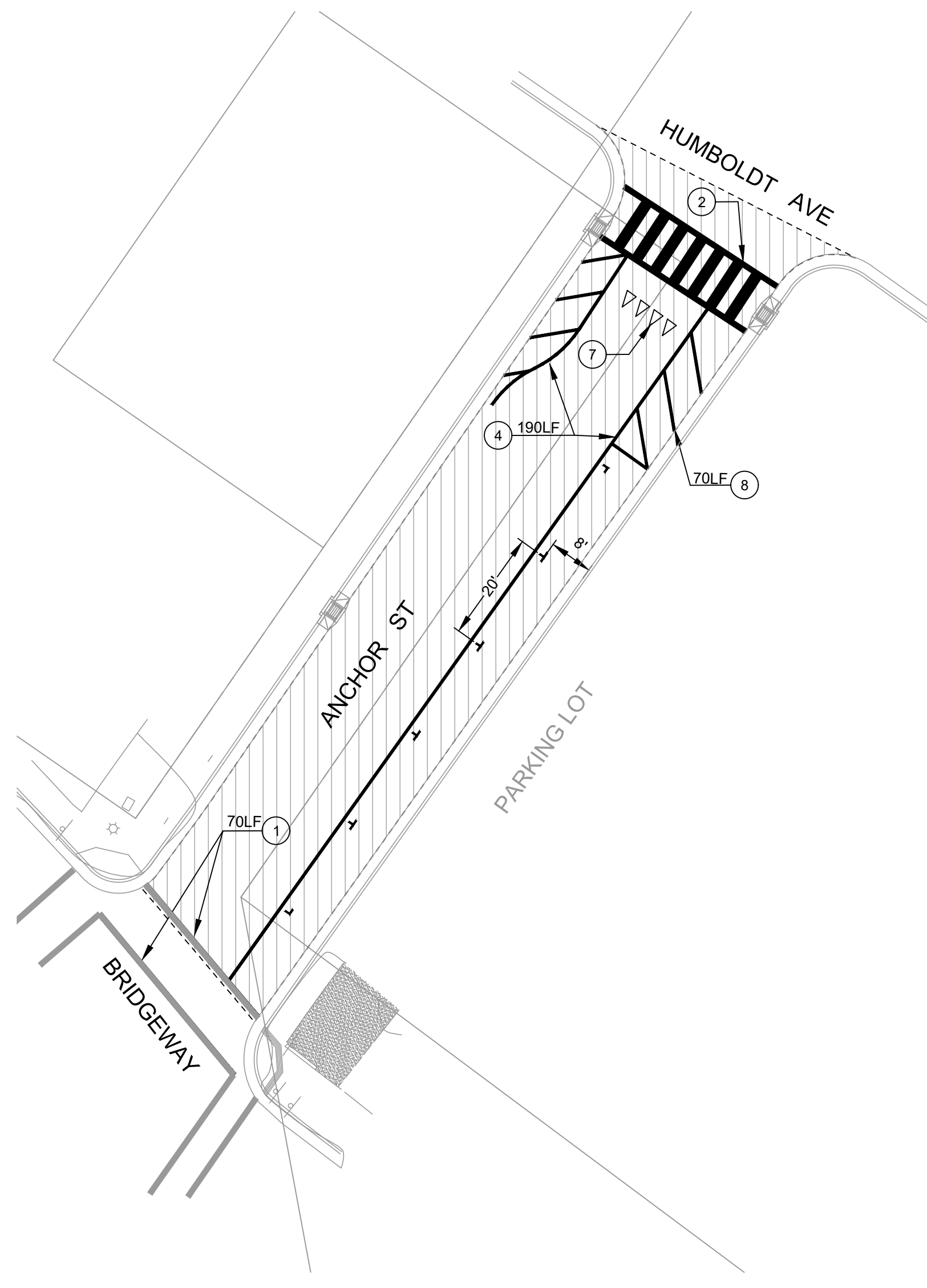

ANCHOR ST
SCALE: 1 inch = 20 ft

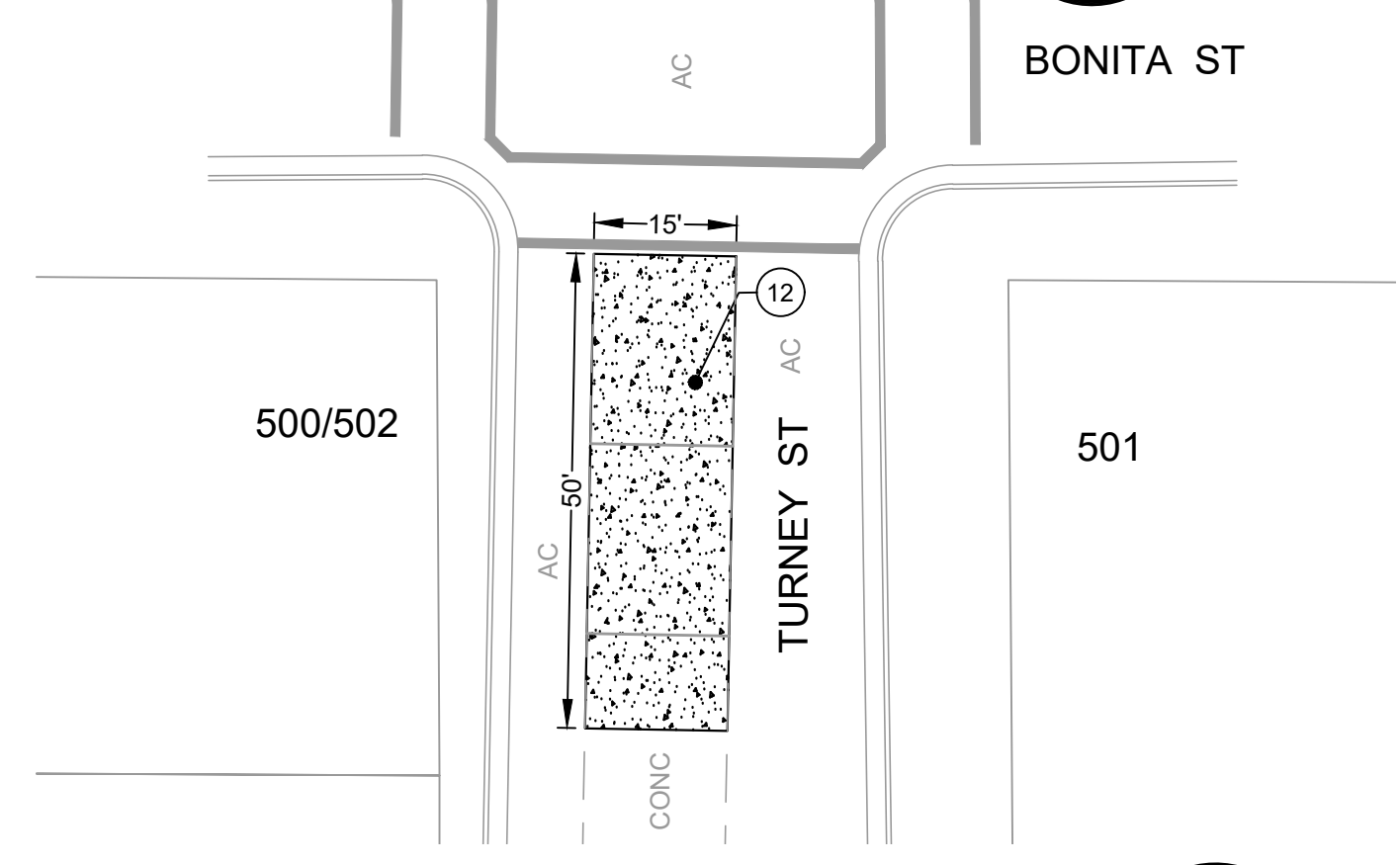

TURNNEY ST (BID ALTERNATIVE #3)
SCALE: 1 inch = 20 ft

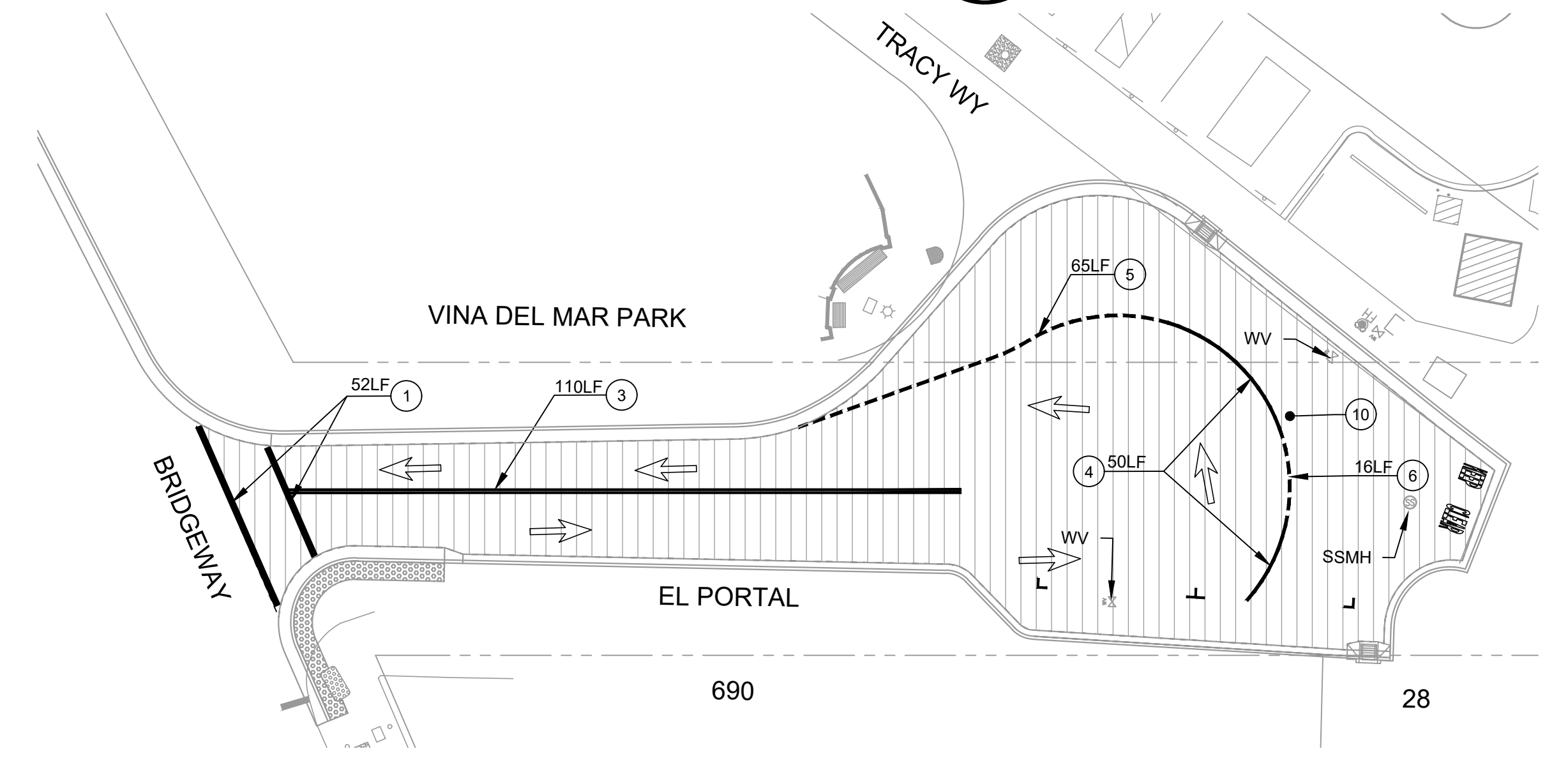

EL PORTAL
SCALE: 1 inch = 20 ft

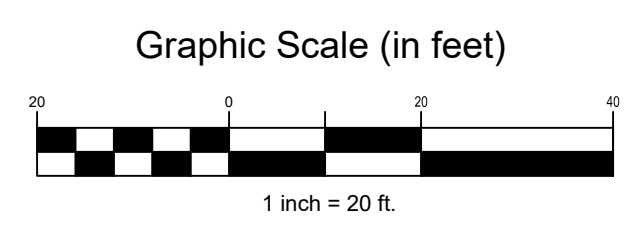

NOTES

1. PAVEMENT STRIPING AND MARKINGS PER CALTRANS STANDARD PLANS.
2. PROTECT IN PLACE ALL UTILITY FRAMES AND COVERS TO GRADE.
3. PROTECT IN PLACE ALL SURVEY MONUMENT COVERS TO GRADE PER UCS DWG 300.
4. APPLY TACK COAT BETWEEN NEW & EX. PAVEMENT.
5. DIGOUT LOCATIONS TO BE MARKED BY ENGINEER.
6. PROTECT IN PLACE EXISTING TRAFFIC SIGNAL LOOPS.

KEYNOTES

1. STOP BAR/LIMIT LINE STRIPE (12-INCH - WHITE) PER CALTRANS STD DETAIL A24E
2. LADDER - CROSSWALK PER CALTRANS STD DETAIL A24F
3. DETAIL 21 - NO PASSING ZONE (CALTRANS STD. PLAN A20A)
4. DETAIL 38A - CHANNELIZING LINE - NO REFLECTORS (CALTRANS STD. PLAN A20D)
5. DETAIL 40 - LANE LINE EXTENSION THROUGH INTERSECTION (CALTRANS STD. PLAN A20D)
6. 4" WHITE STRIPE
7. YIELD LINE - CALTRANS A24E (CALTRANS STD. PLAN A24E)
8. BLUE REFLECTIVE PAVEMENT MARKER
9. EXTEND DASHED CENTERLINE (DETAIL 21) THROUGH INTERSECTION. MATCH EX CONDITION.
10. BLUE REFLECTIVE PAVEMENT MARKER
11. 8" WHITE STRIPE
12. REMOVE & DISPOSE EX CONCRETE PAVEMENT. SCARIFY AND COMPACT 6" OF SUBGRADE TO 90% R.C. OR AS APPROVED BY ENGINEER. INSTALL 5" CONCRETE PAVEMENT WITH 4" BAR @ 18" OC, BOTH WAYS. INSTALL EXPANSION JOINTS 20' OC PER DETAIL 1 ON SHEET 25.

LEGEND

- ROADWAY REHABILITATION, 2" HMA MILL & FILL
- ROADWAY REHABILITATION, MICRO-SURFACING
- PAVEMENT MARKINGS (CALTRANS STD. PLAN A24C, A24D & 24E)

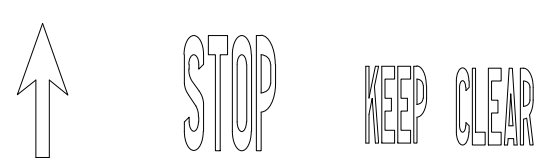

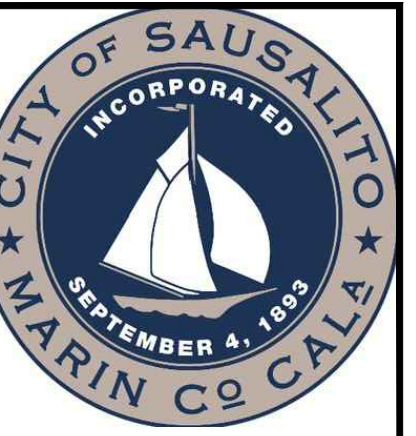

CSW ST2

ENGINEERING
LANDSCAPE ARCHITECTURE
SURVEYING
URBAN PLANNING
504 REDWOOD BLVD #310
NOVATO, CA 94947
415.883.9850
WWW.CSWST2.COM ©2025

Rev	Date	Description	Designed	Drawn	Checked

**SAUSALITO 2024 PAVING
PAVEMENT REHABILITATION
SECOND ST
(RICHARDSON ST to SOUTH ST)
SAUSALITO, CALIFORNIA**

City Of
Sausalito
County Of
Marin
State Of
California

Prepared Under the Direction of:



Sheet
13
Scale: 1 inch = 20 ft.
Date: AUGUST 8, 2025
Sheet Number: 13 OF 25

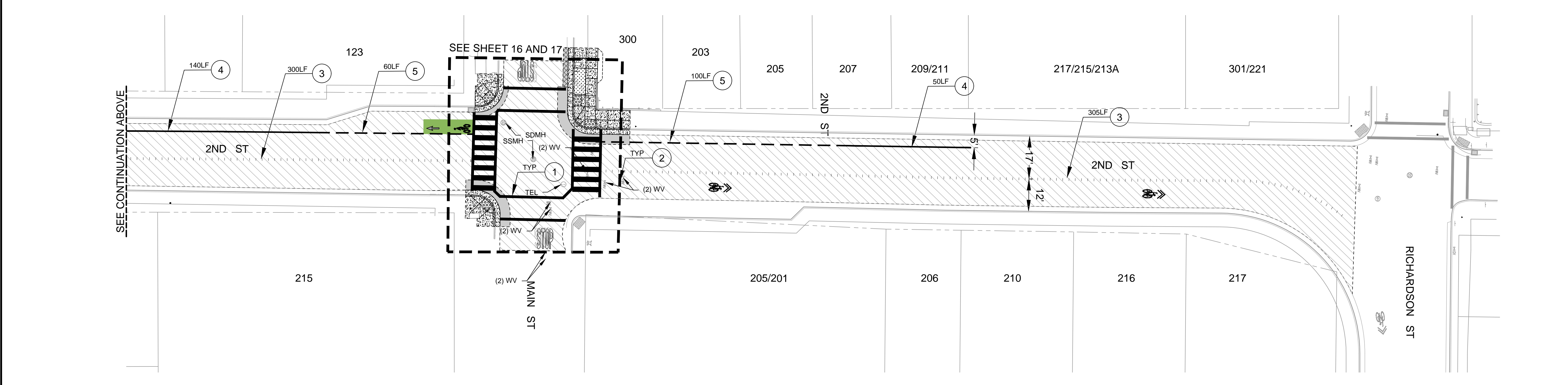
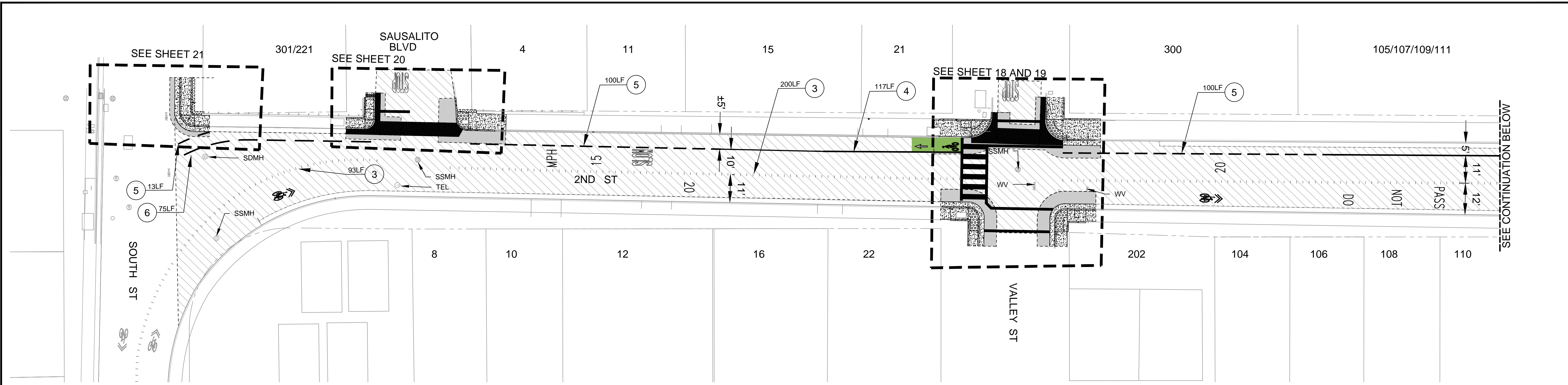

KEYNOTES

- ① BASIC CROSS WALK (12-INCH - WHITE) PER CALTRANS STD DETAIL A24F
- ② LADDER - CROSSWALK PER CALTRANS STD DETAIL A24F
- ③ DETAIL 22 - NO PASSING ZONE (CALTRANS STD. PLAN A20A)
- ④ DETAIL 39 - BIKE LANE LINE (CALTRANS STD. PLAN A20D)
- ⑤ DETAIL 39A - BIKE LANE LINE (CALTRANS STD. PLAN A20D)
- ⑥ DETAIL 40 - LANE LINE EXTENSION THROUGH INTERSECTION (CALTRANS STD. PLAN A20D)
- ⑦ BLUE REFLECTIVE PAVEMENT MARKER

NOTES

1. PAVEMENT STRIPING AND MARKINGS PER CALTRANS STANDARD PLANS.
2. PROTECT IN PLACE ALL UTILITY FRAMES AND COVERS TO GRADE.
3. PROTECT IN PLACE ALL SURVEY MONUMENT COVERS TO GRADE PER UCS DWG 300.
4. APPLY TACK COAT BETWEEN NEW & EX. PAVEMENT.
5. DIGOUT LOCATIONS TO BE MARKED BY ENGINEER.

LEGEND

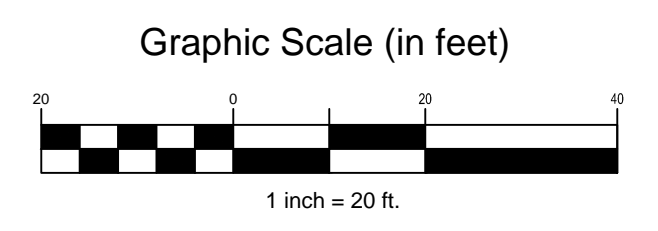
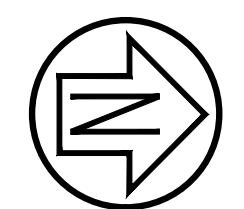
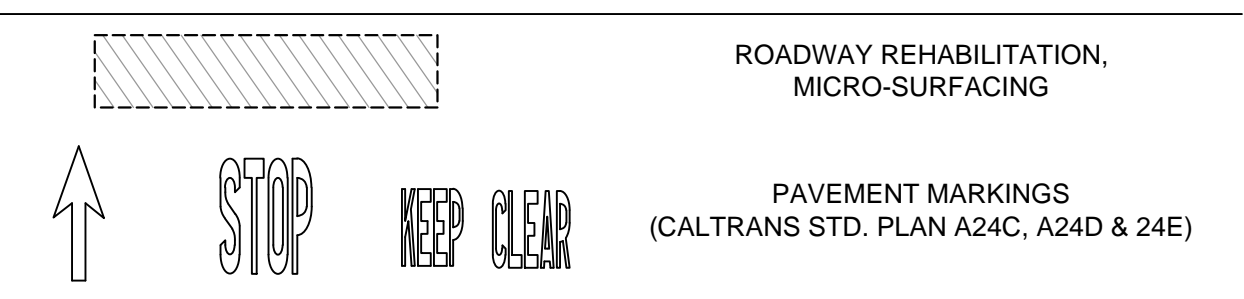

P:\Shared\9803040207 Sausalito 2024 Paving\DWG\CAD\Sheet\13.dwg 10/07/2025 08:18:16 AM 13.002

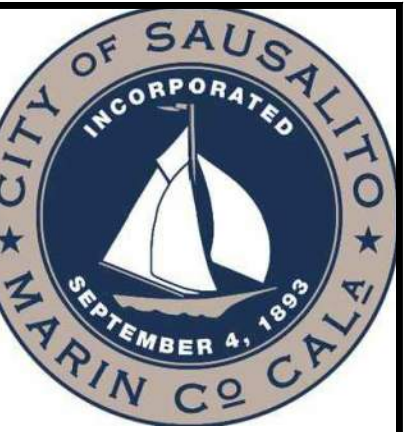

CSW ST2

ENGINEERING
LANDSCAPE ARCHITECTURE
SURVEYING
URBAN PLANNING
504 REDWOOD BLVD #310
NOVATO, CA 94947
415.883.9850
WWW.CSWST2.COM ©2025

Rev	Date	Description	Designed	Drawn	Checked

SAUSALITO 2024 PAVING
CURB RAMP PLAN
2ND ST & SOUTH ST
SAUSALITO, CALIFORNIA

City Of
Sausalito
County Of
Marin
State Of
California

Prepared Under the Direction of:



Sheet
21
Scale: 1 inch = 5 ft.
Date: JULY 30, 2025
Sheet Number: 21 OF 25

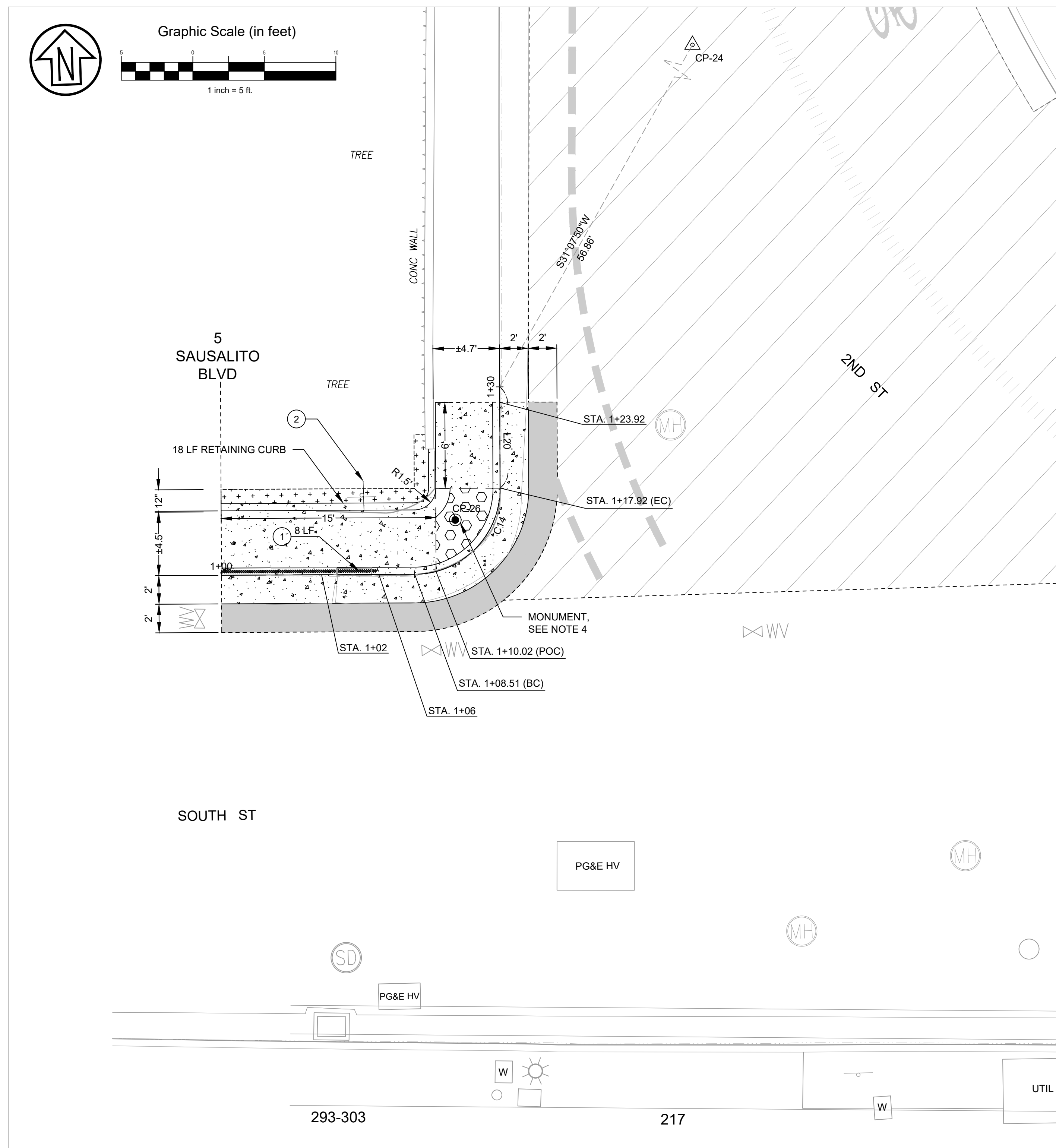

LAYOUT PLAN
1 inch = 5 ft.

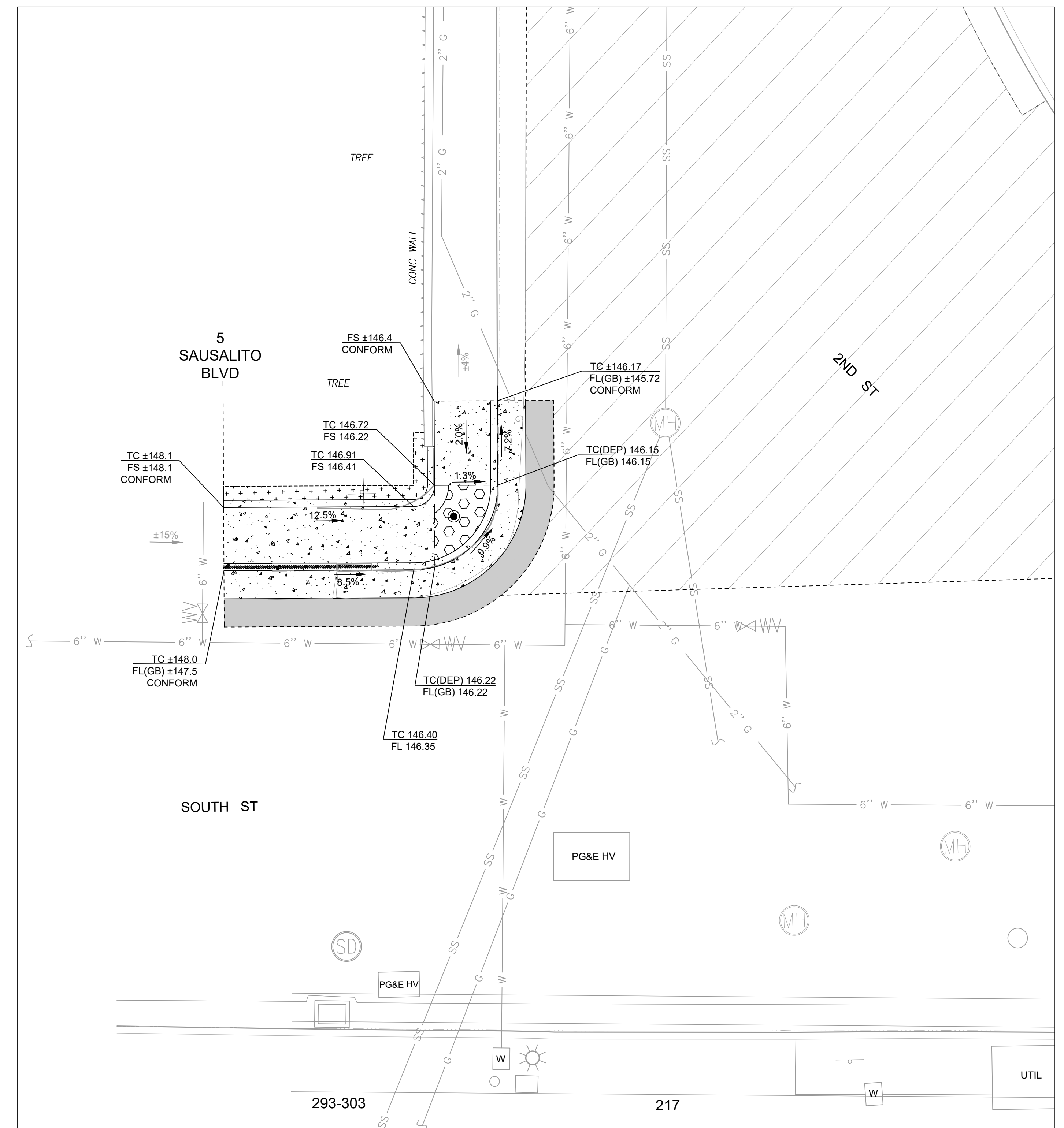

GRADING PLAN
1 inch = 5 ft.

LEGEND

- ROADWAY REHABILITATION, MICRO-SURFACING
- HMA PLUG - 8" DEPTH
- CONCRETE PAVEMENT
- TRUNCATED DOMES
- CLEAR, GRUBB, AND DISPOSE

KEYNOTES

- ① RED CURB PAINT
- ② REMOVE, SALVAGE, AND MOUNT SIGN ON NEW POST PER UCS #310

SOUTH STREET CURB RAMP ALIGNMENT

TAG	STATION	NORTHING	EASTING	DELTA / BEARING	DISTANCE	RADIUS
C14	1+08.51	2136937.44	5989754.11	N46° 27' 14"E	9.42	6.00
L20	1+17.92	2136943.28	5989760.26	N1° 28' 45"E	7.08	

SURVEY CONTROL POINTS

POINT NO.	NORTHING	EASTING	ELEVATION	DESCRIPTION
CP-24	2136999.0404	5989789.8359	144.63	CP FND MNW CURB LAS
CP-26	2136941.1539	5989757.0592	145.82	FND MON 2"BDWP RE 9788

NOTES

- PAVEMENT STRIPING AND MARKINGS PER CALTRANS STANDARD PLANS.
- PROTECT IN PLACE EXISTING SIGNS, EXCEPT WHERE NOTED IN PLANS.
- ADJUST TO GRADE EXISTING UTILITY FRAME, COVERS, BOXES, LIDS, ETC. AS NECESSARY FOR PROJECT IMPROVEMENTS.
- CONTRACTOR SHALL REFERENCE ALL SURVEY MONUMENTS WITHIN LIMITS OF WORK PRIOR TO ANY DEMOLITION. ADJUST MONUMENT COVERS TO GRADE AS NEEDED PER UCS DWG 300.
- APPLY TACK COAT BETWEEN NEW ASPHALT AND EXISTING ASPHALT OR CONCRETE.

